

# SupIR 50mm f/1.2, Fixed Athermalized 680114

TYPICAL ICD\*

LWIR | 1-FOV



**HD**  
FORMAT

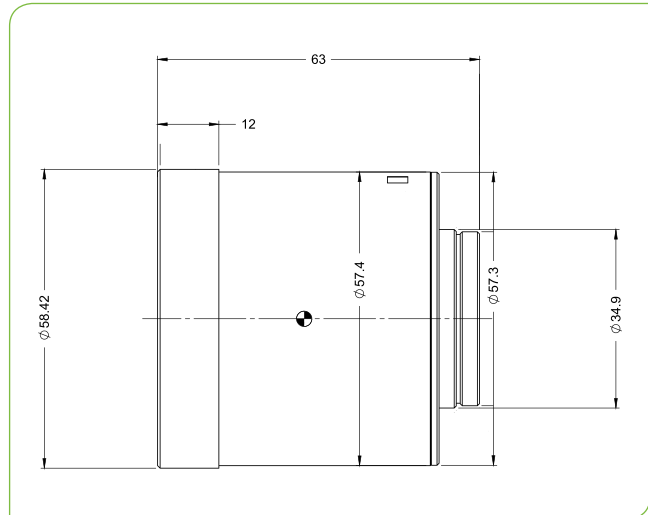

HFOV	320x240	384x288	640x480	1024x768
<b>17μ</b>	6.2°	7.5°	12.4°	
<b>12μ</b>	4.4°	5.3°	8.8°	14.0°

Property	Value				
<b>Optical</b>					
Focal Length	50mm				
F#	1.2				
Average transmission (8-12μm)	94% (HD) / 88% (HC)				
Back Focal Length	33.68mm in air				
<b>Mechanical</b>					
Focus Mechanism	Fixed				
Depth of Field	100m to infinity				
Focus Range	1.5m to infinity				
Weight	238gr				
Max. Dimensions	Ø58.42mm x 63mm				
<b>Environmental</b>					
Operation Temperature	-40°C to +80°C				
Storage Temperature	-55°C to +85°C				
Sealing	IP 67 front element only				
<b>Configurations</b>	<b>Weight (gr)</b>	<b>Dimensions</b>	<b>BWD**</b>	<b>Thread</b>	<b>Coating</b>
680114-001					HD
680114-002	238	Ø58.4mm x 63mm	9.7	M34x0.5	HC
680114-005***					HC

\* The ICD drawing provided here is primarily a representation and may not accurately reflect the product's actual dimensions and specifications. For precise integration specifications contact your local sales representative.

\*\* The BWD value is calculated for a unique detector setup with varying sealing windows in terms of thickness and material. For more details, contact your local sales representative.

\*\*\* Completely sealed